

SSKE18-3

APPLICATIONS

- Sanitary, food & beverages
- Full welded construction
- Zero-leak path design



FEATURES

- Dairy, Ice cream industries
- Pharmaceutical industries
- Sterilization applications
- Oil & Gas applications
- Corrosive environments

HOMOGENIZER PRESSURE GAUGE, SSKE18-1

DESCRIPTION

General

Design : EN 837-3

Accuracy : $\pm 1.6\%$ of full scale

Ambient temperature: -40...+65°C [without dampening liquid]
-20...+65°C [with dampening liquid]

Service temperature : 10...150°C max.

Pressure limits : Steady pressure up to FS value

Fluctuating pressure up to 90% of FS value

Short time 1.3 x FS value for range up to 100 bar

Short time 1.15 x FS value for range above 100 bar

Weld joints : TIG argon arc welding

Material of construction

Sensing element : Diaphragm

Case & Ring material : AISI 304 SS (Bayonet type)

Diaphragm, Bourdon tube & Shank : AISI 316L SS

Movement mechanism : AISI 304 SS

Dial : Aluminum, black graduation on white background

Pointer : Fixed, aluminum, black powder coated

Gaskets & filling plug : Neoprene

Window : Plexi glass

Standard version

Dial size : DN100

Range : -1...600 bar

Mounting pattern : Direct, Bottom connection

Process connection : Flange

Seal filling fluid : Glycerine [10°C to 150°C]

Ingress protection : IP 65

Execution : Dry / Dry but fillable

Filled versions

Glycerin

Window : Plexi glass

Dampening liquid : Glycerin 99.7%

Temperature effect

When temperature of the measuring system deviates from reference temperature (+20°C) :

max error $\pm 0.4\%$ / 10K of true scale value.

FULLY WELDED FLANGED DIAPHRAGM SEAL WITH PRESSURE GAUGE

SSKE18-3

DIMENSIONAL DRAWING

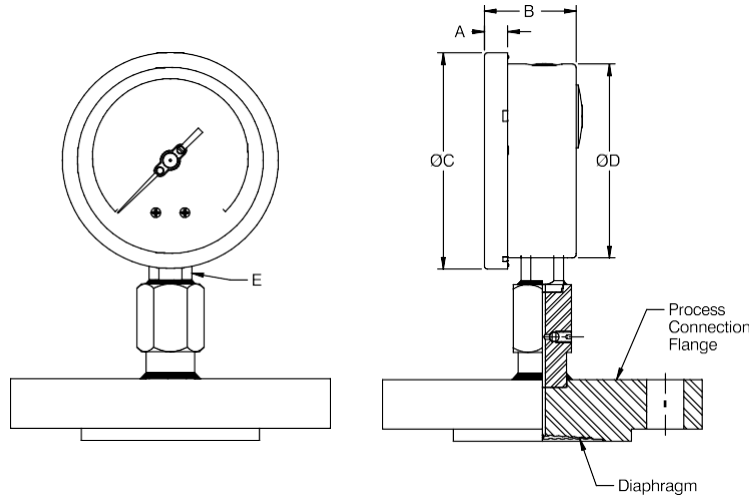

DN	A	B	ØC	ØD	E	Weight (grams)
100	12	48	111	100	SQ.22	5065
150	15	48	161	149	SQ.22	5363

All dimensions are in mm.

ORDERING CODES

MODEL						SSKE18-3				
SSKE18-3 Fully Welded Flanged Diaphragm Seal with Pressure Gauge										
DIAL SIZE										
D4	4" / 100 mm	D6	6" / 150 mm							
MOUNTING										
M01	Direct Mounting									
FLANGE CONNECTION										
FA25	1 1/2" RF 150#	FA26	1 1/2" RF 300#	FA27	1 1/2" RF 600#		FA31	2" RF 150#	FA32	2" RF 300#
CASE FILLING										
F1	Dry	F2	Dry but fillable	F3	Glycerin filled					
WETTED PARTS										
S02	AISI 316 SS	S03	AISI 316L SS							
INGRESS PROTECTION										
I1	IP 65	I6	IP 68							
RANGE										
0-10 bar Please mention range required with the measurement unit [SSKE offer in all types of National & International measurement units, e.g. kg/cm ² , psi, kPa, etc. with single or dual scales]										
OTHER OPTIONS										
E16	5 - point calibration certificate	E31	Custom designed dial	E32	Dial tag marking					
E17	Material test certificate 3.1	E21	Material test certificate 2.2	E28	SS tag plate, AISI 316 SS					
E27	SS tag plate, AISI 304 SS	E47	Crimped case & ring							

Rev00

Technical changes and omissions may happen later.

Ordering Example : SSKE18-1.D4.M1.FA25.F2.S02.I1/0-250 bar/E16/E27

SHREE SAMARTH KRUPA ENGINEERS

Contact : +91 8155865961, +919586682557

prakash@shree-samarthkrupa.com, www.shree-samarthkrupa.com